

Aluthermo®

INSTALLATION GUIDANCE ROOFREFLEX

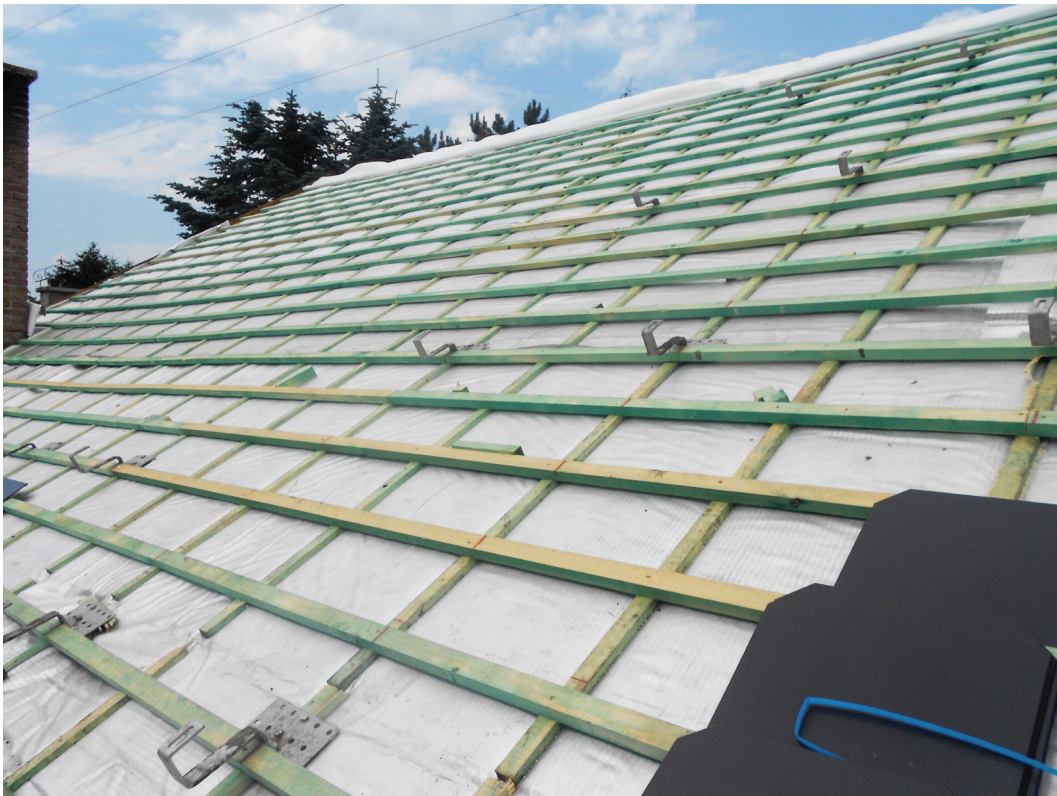

GENERAL

Aluthermo Roofreflex® should be installed according to these instructions and additionally take into account all relevant building regulations. During the installation phase always remove excess rainwater from the exterior of the structural system. The installer should take all measures to prevent damage to the Aluthermo Roofreflex® membrane.

CAUTION AGAINST FIRE

Never expose Aluthermo® ROOFREFLEX® to an intense heat source (welding, flame, sparks, etc.).

Chimney: never put Aluthermo® ROOFREFLEX® in contact with a chimney. Keep a minimum distance of 20 cm from the screen located near chimney ducts and, generally, keep away from any heat source.

In case of welding, remove Aluthermo® ROOFREFLEX®, even if a flame arrestor is present, and always ensure that it is not exposed to the projection of flaming debris or sparks.

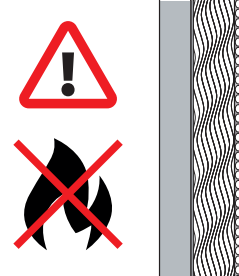

INSTALLATION GUIDANCE :

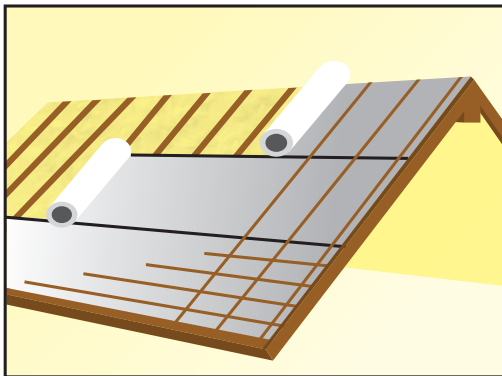

This insulated roof underlay product is a laminate made from a low emissivity reflective membrane and white polyester insulation. The reflective side should be installed facing to the outside of the construction. The first layer should be unrolled parallel to the bottom of the roof. The lap joint with the integral adhesive tape strip always faces down.

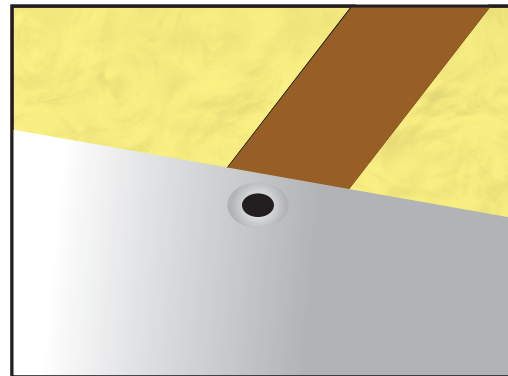

Temporary attachment is then made about 30mm from the upper edge of the lap joint by means of suitable BS 5543 fixings. Battens or counter battens are fixed permanently later on during the installation process.

The longitudinal lap joint is then stuck together with the integral adhesive tape strip.

VERTICAL JOINTS

The vertical joint always has to be done above a rafter. In order to make this vertical lap joint between two strips of Aluthermo Roofreflex®, the polyester insulation from the layer that is to be joined to, is detached from the back of the reflective membrane and a 200mm wide flap is created across the width of the roof membrane using the Aluthermo accessory scissors, taking care not to damage the reflective side. Then the Aluthermo Roofreflex® joint is butted together on the middle of the rafter. The lap joint that you have just created is then folded back down. For a tension-free bonding of the connection strip, first the counter batten has to be fixed and only after that the Aluthermo black system tape is placed.

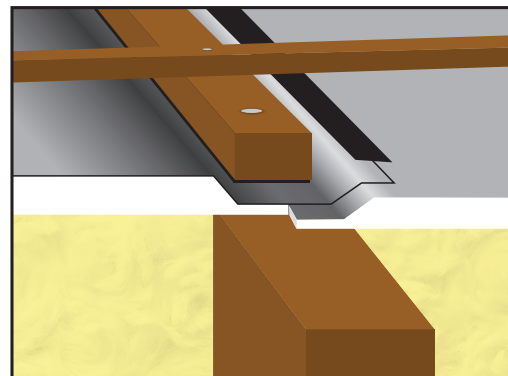

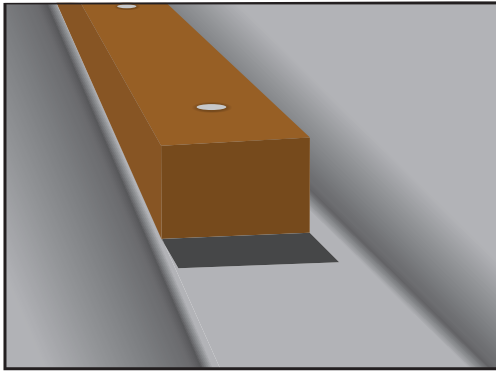

DAFA NAIL SEALING STRIP

Counter battens must have a thickness of at least 4 cm. Before fixing them be sure to apply the waterproofing strip Aluthermo system nail sealing or equivalent between the counter batten and Aluthermo Roofreflex®.

AT THE GUTTER

The bottom edge with the adhesive strip drapes into the gutter or is attached to a felt support tray.

The second layer of Roofreflex® should be unrolled parallel to the first, making sure that the polyester insulation of each strip of Aluthermo Roofreflex® is placed edge to edge.

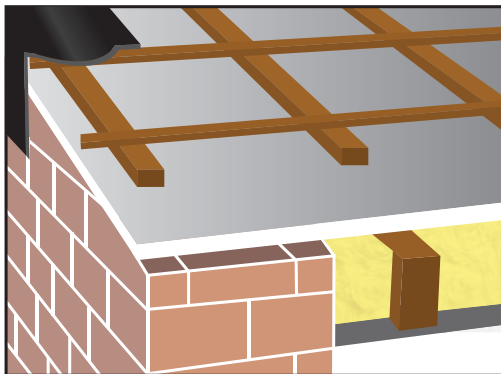
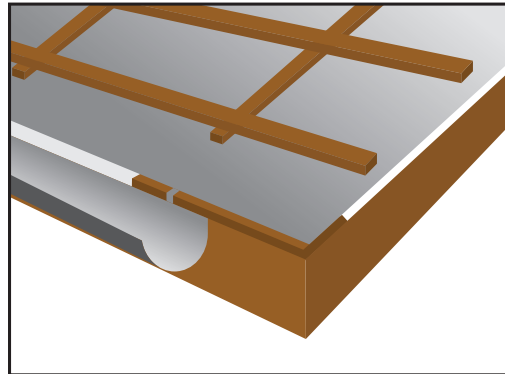

GABLE END

The Aluthermo Roofreflex® ends at the inner edge of the outside vertical edge of the gable, making sure the membrane fully covers the cavity.

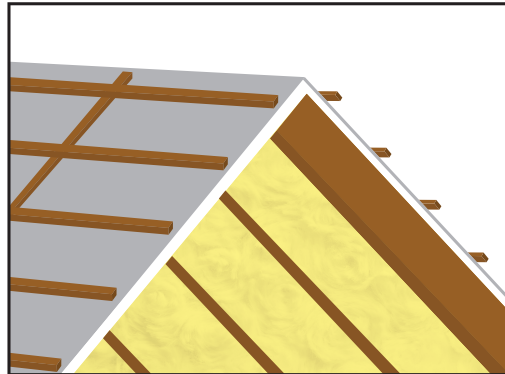

RIDGE

Aluthermo Roofreflex® should normally be installed over the apex of the roof and a lap joint made with the leading edge, which is then sealed down to the next layer on the opposite side with Novia breather membrane lap tape making sure you remove a 100mm strip of the polyester insulation from the back of the lapping joint so that a double thickness section is not created.

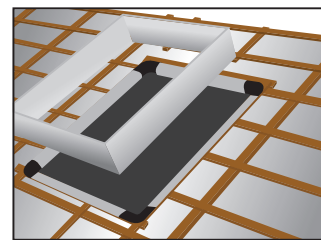
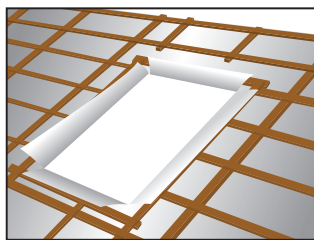
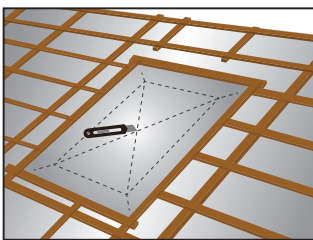

SKYLIGHTS

Follow the installation advice of the of the skylight manufacturer. Draw the position of the skylight onto the membrane and cut along the two diagonals. Next detach the polyester insulation and fold back the membrane. Install the skylight. The insulation is then cut to frame the skylight. Fold the membrane back over the wooden frame. Take it up to 50 mm beyond the top edge of the frame. Cut off the surplus. Seal the edges with Aluthermo black system tape.

VALLEYS

In valleys unroll a length of Aluthermo Roofreflex® lengthways creating a valley runner into the “V” of the valley, fix the outer edges with BS 5543 fixings to the roof timbers making sure not to puncture the membrane in the actual valley, then place the horizontal sections of Aluthermo Roofreflex® into the valley and cut to rake, making sure that the insulation is cut back to the angle of the runner so that the flap of membrane can easily cover the fixings by at least 100mm before sealing with Novia breather membrane lap tape. If a thick valley board is used and the membrane proves to be too “bulky” then use a continual strip of standard Novia Reflex as the valley runner and finish as above.

AIR VENTS

The membrane should be cut to a slightly smaller diameter than the size of the air vent. The joint should be sealed with Aluthermo black system tape.

Aluthermo - quality guaranteed



EFFECTIVE. THIN. EASY TO INSTALL.

ALUTHERMO S.A.
Steinkelt, Galhausen 23
4780 ST. VITH
BELGIUM

Tel. : +32(0)80 77 10 28
Fax : +32(0)80 54 90 29
info@aluthermo.be

www.aluthermo.com